

The 2500 Riding Greens Mowers

2500B PrecisionCut™, 2500E E-Cut™ Hybrid



The only riding greens mowers
everyone can appreciate.

Performance. Reliability. Value. These machines can really cut it.

► Superintendents. Managers. Technicians. Players. They all judge the quality of your greens — and the performance of your greens mowers.

Which is why we made sure the 2500 Riding Greens Mowers deliver a cut everyone can appreciate, no matter how demanding the course. They help technicians and operators be more productive and efficient while superintendents and managers will appreciate the bottom line savings.

The 2500 Riding Greens Mowers strike a balance between the hard work it takes to cut, every day — and the soft touch it takes to keep greens looking their best. And they do it all affordably.

Whether you choose the 2500B PrecisionCut or the 2500E E-Cut Hybrid — you get a machine that makes sense and makes your job easier. As well as equipment that proves just how committed John Deere is to meeting your needs.



► 2500B PrecisionCut



► 2500E E-Cut Hybrid

The 2500 Riding Greens Mowers.

The best way to approach the green.

Nothing on your course gets more scrutiny than the greens. Which is why the 2500 Riding Greens Mowers offer features to help you achieve stunning results. Features like exclusive offset cutting units to reduce “triplex ring.” Or Quick Adjust cutting units to make it easy to set the height of cut. And if you’re ready for hybrid technology, E-Cut Hybrid technology is right for you. Since 2005, John Deere has been introducing customers to the many benefits of this fuel saving system that eliminates all hydraulics from the reel circuit.

4 The 2500 Riding Greens Mowers

We’ve made quality of cut, ease of operation and convenient service a top priority. The 2500B PrecisionCut and the 2500E E-Cut Hybrid Riding Greens Mowers are the result.

6 2500E E-Cut Hybrid

Using a proven design that drives the cutting units with electric reel motors, the 2500E eliminates 102 potential leak points in the reel circuit.

9 Options

12 Specifications



Technicians' Toolbox

Discover how to get maximum performance and ultimate reliability out of your John Deere riding greens mower. You'll find the Technicians' Toolboxes scattered throughout this brochure.



A superior clean up cut. For a flawless finish.

► The quality of the cut affects more than the look of your course. It affects how it plays, and as you know — that's what really matters in the end. The 2500 Riding Greens Mowers have been designed to meet the demanding needs of golf course superintendents who place a high value on consistency of cut, and the ability of cutting units to steer and reliably follow contours. For a truly flawless finish and a better round of golf.

The 2500's superior cutting performance starts with the Quick Adjust 5 cutting units with bedknife geometry that effectively cuts grass and reduces thatch build-up. To ensure an even, consistent cut, a bedknife shoe eccentric on both ends of the bedknife can be rotated to maintain the same geometry during the life of the reel. What's more, Quick Adjust cutting units offer easy height-of-cut adjustment — it only takes a few seconds. But that's just the beginning.

Thanks to an exclusive offset cutting unit design, the 2500 Riding Greens Mowers greatly reduce "triplex ring," which is caused by tire compaction from riding in the same pattern everyday. By simply alternating the direction of the cleanup cut every day, you can dramatically reduce the number of times the tires run over the same turf. This gives the turf an extra day to recover before being driven on again, which minimizes compaction.

Additionally, the tires are located well inside the cutting units to reduce or eliminate double rolling during straight-line passes.

With high strength tubular steel frames, low profile tires and a wide footprint, our riding greens mowers have one of the lowest ground pressures in the industry. And the simple, durable ball-joint suspension



system provides exceptional contour-following and steering with up to 18 degrees of side-to-side motion, and adjustable fore and aft motion. There is no scrubbing in turns or unevenness of cut.

The suspension of the 2500 Riding Greens Mowers offers another advantage that has a big impact on quality of cut. The weight of the grass clippings is carried by the lift arm, not



by the cutting unit roller, so the height of the cut stays consistent as the catchers fill. And since operators typically mow three greens before emptying the catchers,

managing the weight of the clippings better means outstanding quality of cut on all eighteen holes.

The advantages of the 2500 Riding Greens Mowers go all the way down to the tires. New for 2012, you can order a heavier-duty four-ply tire, perfect for moving through courses with rougher terrain such as gravel paths.

The offset cutting units greatly reduce triplex ring with a simple change in direction.



Technicians' Toolbox

The bedknife-to-reel adjustment is a simple, precise notch-based system. The bedknife shoe eccentric can be rotated to keep the same geometry during the life of the reel. In every way, these cutting units have set a new standard.

The tires are well inside the cutting units to reduce or eliminate double rolling, and the offset design minimizes compaction and turf wear in the clean-up cut.

They cut everything beautifully. Even costs.

► The 2500E E-Cut Hybrid riding greens mower is a world-class cutting machine that delivers the kind of cut the game requires — and players demand. At the same time, it cuts noise, cuts maintenance time and cuts fuel consumption. All with exceptional dependability and power.

Confidence

Since 2005, the 2500E E-Cut Hybrid has been introducing golf courses around the world to the advantages of hybrid technology. It's eliminated 102 potential leak points, ensured a more consistent cut, reduced fuel consumption and lowered noise levels.

Now with second-generation motors, the 2500E employs a new efficient 100 amp alternator to power the electric reel motors, eliminating hydraulics from the reel circuit. Fuel and noise levels can be lowered since the mower can be effectively run at reduced engine RPM. And since the reels are powered independently of the engine, the frequency of clip stays constant — even at the reduced engine RPM.



Technicians' Toolbox

Scalping and verticutting operations can be performed with the engine at full throttle.



Performance

Both the 2500E E-Cut Hybrid and the 2500B PrecisionCut Riding Greens Mowers offer a 21 hp* (15.7 kW), 617 cc liquid-cooled gas engine or a 19 .6 hp (14 .6 kW), 784 cc diesel engine. Both have the power you need to get the job done, and then some.



Ease Of Maintenance

We've made sure the 2500E E-Cut Hybrid is as easy to maintain as a conventional mower. The Speed Link™ height-of-cut adjustment system adjusts both sides of the rear roller at once. The hood tilts back for easy engine servicing, with all daily service checks done from the left side of the machine. All fluid levels are easy-to-see and easy-to-check. And the brushless electric motors require no routine maintenance.

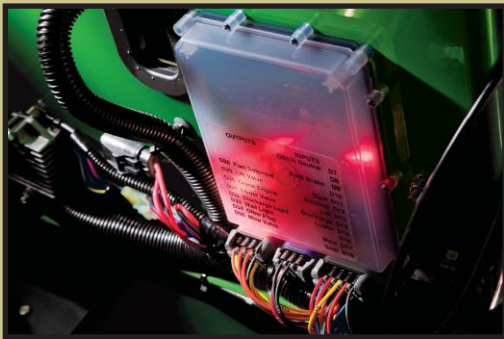

On-Board Diagnostics

On-board diagnostics let you quickly analyze the electrical system. They check the system every six seconds to ensure peak performance. Sit-on-seat diagnostics and the easy-to-read White Box system allows service issues to be diagnosed quickly

without having to hunt through an operator's manual or call a distributor.

Value

You'll save on fuel with the 2500E E-Cut Hybrid. You'll enjoy less noise. And you'll find it surprisingly affordable across the board.



Technicians' Toolbox

One pin located at the front of the lift arms removes the cutting units from the traction unit with no tools.

Quick-Attach cutting unit motors — just loosen the two hold-down bolts that ensure the motors stay tight and secure during operation, twist the motor, and pull it out away from the cutting unit and place in the convenient new storage location.

The kind of cutting units you want: **quick and easy.**

► The cutting units on all our 2500 Riding Greens Mowers let you make all adjustments quickly and easily.

The revolutionary Speed Link™ system makes it possible to adjust height of cut, to both sides of the cutting unit, in no time. A linking bar connects both sides of the rear roller to a high reduction ratio worm gear, allowing for one-thousandths-of-an-inch adjustments to both sides of the roller simultaneously — with a cordless drill or 16mm wrench.

A simple, precise notch-based system is used for bedknife-to-reel adjustment. The bedknife shoe eccentric can be rotated to keep the same geometry during the life of the reel. In every way, these cutting units have set a new standard.

Of course, we've gone to great lengths to make sure the cutting edges keep their edge. The right amount of chromium and carbon make sure our bedknives are strong and longwearing. And our high-strength steel reels, with a high carbon content, ensure long wear life, reduced maintenance and resistance to breakage.



The grass catchers have been designed for optimum catching efficiency. The weight of the grass clippings is transferred to the lift arm in order to maintain a consistent height of cut. An improved center unit also gives you

easier access than ever before — removal and installation is both simple and quick.





They do plenty. And with these options, they'll do plenty more.

The 2500 Riding Greens Mowers come with plenty of optional equipment to deliver the highest cut quality in the industry. And being a cut above is something everyone appreciates.

1. MT Grooved and NEW MTSpiral Grooved Roller

The new MTSpiral rollers achieve what no other roller can — they greatly reduce roller overlap marks. With traditional roller setups, the grass can be rolled four times in the overlap of the front and rear cutting units. But with MTSpiral rollers, the grass is rolled only twice at every point. The material in the overlap of the roller is machined to allow the ends of the rear cutting unit rollers to roll right through the open space of the front cutting unit rollers.
NOTE: For fairway use only.

2. Rear-attaching Yoke Kit

Designed for fairways and surrounds applications, the yoke is attached at the rear of the cutting unit instead of the front, transferring the necessary force onto the rear rollers to mow in these specific areas of the course - not for use on greens.

3. Greens Tender Conditioner and Rotary Turf Brush

For the ultimate in cut quality, add a Greens Tender Conditioner (GTC) or Rotary Turf Brush — that rotates counter to the reel to stand grass up prior to cutting. The GTC also slices stolons to promote new growth.

4. Rear roller power brush

Prevents accumulation of grass clippings and other debris on the rear roller, for a consistently effective height of cut.

5. Rollers

Add a smooth roller during seasonal or regional conditions when the greens may be wet, soft or stressed — or pick a machined groove roller with continuous grooves for a more aggressive cut quality.

6. QA5 Verticutter

The carbide-tipped verticutter is ideal for dethatching, slicing rhizomes and stolons, and promoting more vigorous turf density on playing surfaces. Counter-weighted for consistent performance. Maximum depth penetration 0.125 in. (3.1 mm).

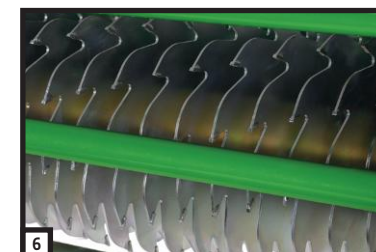
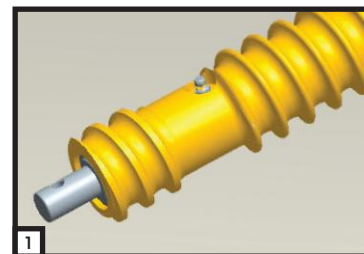

Technicians' Toolbox

With a greens mower, 90% of hydraulic leaks occur in the reel circuit. These hydraulics are completely eliminated from the 2500E E-Cut Hybrid.

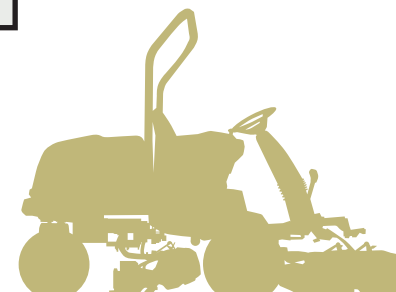

Less fuel, less noise — with even more cut quality.

When operated at reduced throttle, the 2500E E-Cut Hybrid reduces fuel usage and sound levels, without compromising cut quality. A 48-volt alternator powers reels at a constant 2200 rpm. And unlike a battery, which drains over time, the 2500E E-Cut Hybrid's alternator stays at a constant power level, delivering the same quality of cut on the first green as it does on the eighteenth.

The 2500E E-Cut Hybrid system allows for the reels to maintain 2200 rpm while the engine runs at lower rpm's, reducing sound levels and fuel consumption.



Technicians' Toolbox

The 2500E E-Cut Hybrid gas is the industry's quietest engine-powered riding greens mower according to ISO standards.

102 hydraulic leak points have been eliminated on the 2500E E-Cut Hybrid, since all the hydraulics have been removed from the cutting unit drive circuit.

The 2500E E-Cut Hybrid electric brushless reel motors require no routine service.



The reels are powered by an alternator. Better than a battery, this provides consistent power all day long.

A more comfortable operator is a more **productive** operator.

Both the 2500B Precision Cut and the 2500E E-Cut Hybrid are designed for comfortable, easy operation and greater productivity. The fact is, equipment that's easy to use makes tough jobs easier. For a better cut and superior end result.

The operator station is an ergonomic achievement — providing an excellent view of all the cutting units. The Command Arm combines your raise/lower lever, mow engagement lever, throttle, key switch and more. It's logical and convenient — and it moves with the seat. A convenient cup holder is even located on the control arm for easy access.

In addition, both machines give you the peace of mind that comes from knowing you're working with equipment that combines forward-thinking with the tried and true — for better productivity and powerful end results.



The CommandArm control center puts operator controls at your fingertips. It moves with the seat to ensure the ANSI-standard color-coded controls are right where you need them.**



Seat is positioned to handle small and large operators with a wide range of adjustment.

ROPS meets ISO safety standards.*

Adjust the 5-position tilt steering column with an accessible foot control.

Foot operated brake is in front of operator so it's always accessible.

The forward and reverse foot pedals are easy to identify.

*2-Post SAE J21294 Roll Over Protection Structure (ROPS) with Seat Belts meets ISO 21299 standards
**ANSI B71.4-2004

Specifications

	2500B PrecisionCut - Gas	2500B PrecisionCut - Diesel	2500E E-Cut Hybrid - Gas	2500E E-Cut Hybrid - Diesel
Engine				
Type	Liquid Cooled Gas, 2-cylinder	IDI Diesel, 3-cylinder	Liquid Cooled Gas, 2-cylinder	IDI Diesel, 3-cylinder
Maximum rated horsepower	21 hp*† (15.7 kW) @ 3,600 rpm	19.6 hp (14.6 kW) gross @ 3,000 rpm, PS	21 hp*† (15.7 kW) @ 3,600 rpm	19.6 hp (14.6 kW) gross @ 3,000 rpm, PS
Displacement	585 cc	784 cc	585 cc	784 cc
Air cleaner	Semi-cyclone, dry-type, dual-stage	Semi-cyclone, dry-type, dual-stage	Semi-cyclone, dry-type, dual-stage	Semi-cyclone, dry-type, dual-stage
Cooling system	Liquid	Liquid	Liquid	Liquid
Oil filter	Full-flow filter	Full-flow filter	Full-flow filter	Full-flow filter
Engine oil capacity	2.0 US qt. (1.7 L) w/filter	3.1 US qt. (2.6 L) w/filter	2 US qt. (1.7 L)	3.1 US qt. (2.6 L) w/filter
Pressurized lubrication system	Standard	Standard	Standard	Standard
Engine certification	Meets CARB and EPA	Meets EPA Tier 2, Interim Tier 4, and Tier 4	Meets CARB and EPA	Meets EPA Tier 2, Interim Tier 4, and Tier 4
Electrical System				
Charging system	Flywheel, alternator	Flywheel, alternator	Flywheel, alternator	Flywheel, alternator
Alternator capacity	16 amp	20 amp	16 amp	20 amp
Ignition	CDI	–	CDI	–
Battery type	12-volt, BCI group 40 maintenance-free	12-volt, BCI group 40 maintenance-free	12-volt, BCI group 40 maintenance-free	12-volt, BCI group 40 maintenance-free
Starter	Electric (solenoid shift)	Electric (solenoid shift)	Electric (solenoid shift)	Electric (solenoid shift)
Vehicle				
Drive wheels	Front	Front	Front	Front
Traction drive	Hydrostatic, 2-pedal control	Hydrostatic, 2-pedal control	Hydrostatic, 2-pedal control	Hydrostatic, 2-pedal control
Reel drive	Hydraulic	Hydraulic	Electric	Electric
Pump	3-section gear	3-section gear	Alternator, 48 volt/100 amp	Alternator, 48 volt/100 amp
Reel control valves	Electro-hydraulic, one valve reel on-off and one valve raise-lower	Electro-hydraulic, one valve reel on-off and one valve raise-lower	N/A	N/A
Filtration	10 micron	10 micron	10 micron	10 micron
Electrical and Safety System				
Diagnostics	On-board diagnostics with White Box Controller and (SOS) Sit on Seat Diagnostics	On-board diagnostics with White Box Controller and (SOS) Sit on Seat Diagnostics	On-board diagnostics with White Box Controller and (SOS) Sit on Seat Diagnostics	On-board diagnostics with White Box Controller and (SOS) Sit on Seat Diagnostics
Safety interlocks	Operator presence switch (in seat), backlap switch, mow/transport switch, park brake set switch	Operator presence switch (in seat), backlap switch, mow/transport switch, park brake set switch	Operator presence switch (in seat), backlap switch, mow/transport switch, park brake set switch	Operator presence switch (in seat), backlap switch, mow/transport switch, park brake set switch
Weights				
Weight (full fluids, no operator or fuel)	1,233 lb. (559.2 kg)	1,405 lb. (637.3 kg)	1,281 lb. (581 kg)	1,405 lb. (637.3 kg)
Height	77 in. (195.6 cm) w/ROPS	77 in. (195.6 cm) w/ROPS	77 in. (195.6 cm) w/ROPS	77 in. (195.6 cm) w/ROPS
*The engine horsepower and torque information are provided by the engine manufacturer to be used for comparison purpose only. Actual operating horsepower and torque will be less. Refer to engine manufacturer's web site for additional information.				
†Engine Manufacturer Gross Power. Tested in accordance with SAE J1995.				

Standard on all models	
Vehicle	
Front/rear wheels and tires	18x10.5-10, 2-ply, smooth (low compaction); 20x10-10, 2-ply, smooth; or 20x10-10, 2-ply, turf
Brakes	Single-pedal, 2-wheel disc brakes
Type	Dual, 6 in. (15.2 cm)
Mowing speed	0 to 4 mph (0 to 6.4 km/hr), adjustable mow stop
Transport speed	0 to 8.5 mph (0 to 13.7 km/hr)
Reverse speed	0 to 3 mph (0 to 4.8 km/hr)
Ground clearance with catcher	4 in. (10.2 cm)
Fuel tank capacity	7.9 US gal. (29.9 L) in a single tank
Muffler	Horizontal discharge below frame
Hydrostatic drive system capacity	7.6 US gal. (28.8 L)
Hydraulic reservoir capacity (only)	5.4 US gal. (20.4 L)
Instrumentation	
Engine oil pressure	LED warning light
Alternator	LED warning light
Hydraulic oil temperature	LED warning light
Engine coolant temperature	LED warning light
Hourmeter	Digital
Operator Controls	
Steering	Hydrostatic, adjustable steering column
Reel drive and reel lift	Right-hand operated
Throttle	Right hand
Park brake	Right foot
Forward	Right foot
Reverse	Right foot
Ignition	Key start and shutoff
Glow plug switch and indicator light	Automatic, on instrument panel on diesel models
Dimensions	
Wheelbase	51.0 in. (129.5 cm)
Tread width	40.0 in. (101.5 cm)
Mowing position width	62.0 in. (157.5 cm)
Turning radius, uncut circle	18 in. (45.7 cm)
Certification	
Number	ANSI B71.4-2004
ROPS	2-post SAE J21294 Roll Over Protection Structure with seat belts meets pending ISO 21299 standards

	2500B – Gas	2500B – Diesel	2500E – Gas	2500E – Diesel
Sound Levels at Operator Ear				
Full engine rpm, GTCs and power brushes, reels engaged	81 dB(A)	84 dB(A)	80 dB(A)	84 dB(A)
Reduced engine rpm (2,250) with GTC and power brush attachments	N/A	N/A	76 dB(A)	78 dB(A)
Measuring standard	ISO 11201	ISO 11201	ISO 11201	ISO 11201

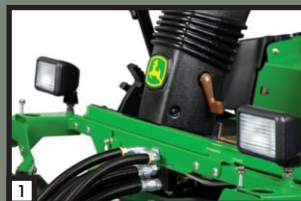

Options:

Light kit [1]
Dew whip holder bracket [2]
Greens mower convenience kit [3]
Rear roller power brush
Greens Tender™ Conditioner
Verticutter
Rollers
Rear-attaching yoke kit

Cutting units on all models:

Number	3, offset design
Size	Quick Adjust QA5 22-in. (55.9 cm) floating
Backlapping	Standard on-board micro-backlapping and reel speed control
Clip frequency	0.045 in./mph (0.71 mm/km/hr) with 11-blade reel; 0.072 in./mph (1.14 mm/km/hr) with 7-blade reel
Front rollers	Optional 2 in. (5.1 cm) smooth, grooved or spiral
Reel diameter	5 in. (12.7 cm)
Bedknife adjustment	Bedknife-to-reel
Height of cut	5/64 to 3/4 in. (2.0 to 19.0 mm) with 2-in. (5.1 cm) front roller; or 5/8 to 1.25 in. (16 mm to 32 mm) with 3-in. (7.6 cm) front roller
Number of blades	7 or 11 blades
Mower lift	(1) Cylinder for front two units; (1) cylinder for rear unit
Reel speed	Adjustable



John Deere service and support. Over a century of forward-looking machines—and backing them up.

John Deere Parts & Service

At John Deere, we understand that timely, cost-effective parts and service are vital to keeping your course running smoothly and your equipment operating at its best. That understanding impacts everything we do. It's why keeping your equipment up and running is job number one. Our local distributor partners have access to our factory-trained technicians, a comprehensive parts inventory and a commitment to keep your course playing.

It's why you'll always get the John Deere part you need right away. In those rare instances when a part is not in stock, you'll have it the next day.



John Deere offers a comprehensive range of financial solutions that are well above par.

Chances are your golf course is seasonal. That's why many of our finance options (revolving, installment and leasing) are set up to account for the variations in your available cash flow during the year.

No other golf maintenance equipment manufacturer has its own financial arm. None. Our team knows the industry, so when you turn to us, you'll find a level of stability and strength that's unparalleled in this industry. This allows us to be more flexible and more responsive to the realities of today's economy.

You'll get access to comprehensive financial solutions — monthly payment plans, seasonal payment plans, leasing options and more — shaped around your needs and your cash flow. And a true golf industry expert will be dedicated solely to the success of your course.

After more than a century of supporting professionals who make their living working the land, we know what it takes to help you succeed.





We take your greens as seriously as you do.

► Find out more about the 2500 Riding Greens Mowers — and what a serious difference they can make on your course. More importantly, experience one for yourself. Ask for a demo on your course today.



OFFICIAL
GOLF COURSE
EQUIPMENT
SUPPLIER



This literature has been compiled for worldwide circulation. While general information, pictures and descriptions are provided, some illustrations and text may include finance, credit, insurance, product options and accessories NOT AVAILABLE in all countries or regions, and in some countries products and accessories may require modifications or additions to ensure compliance with the local regulations of those countries. PLEASE CONTACT YOUR LOCAL DEALER FOR DETAILS. John Deere reserves the right to change specifications, design and price of products described in the literature without notice. John Deere, the leaping deer symbol, and John Deere's green and yellow trade dress are the trademarks of Deere & Company.



JOHN DEERE
GOLF

1-800-537-8233
JohnDeere.com/Golf